

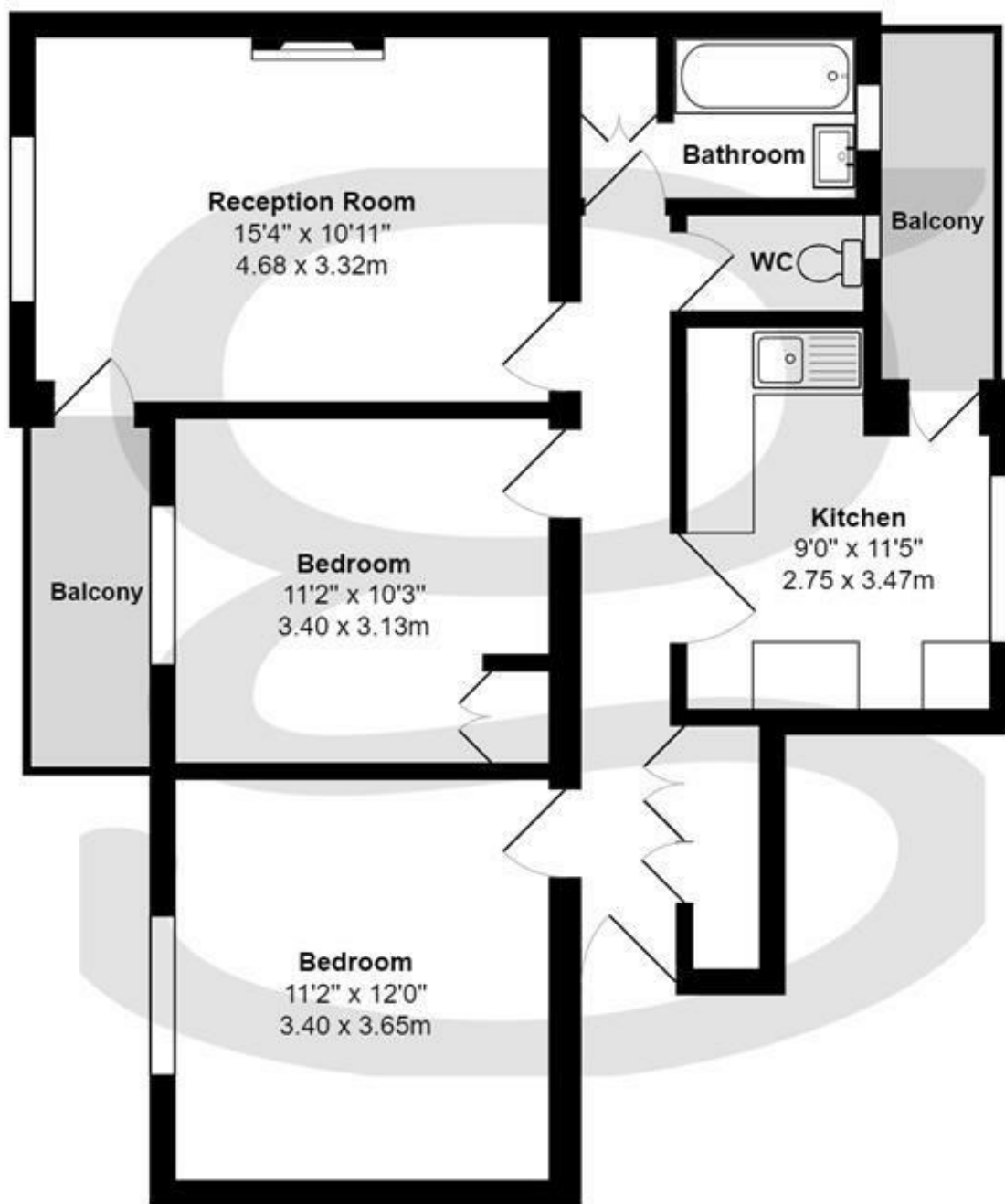

## Boundary Road, St Johns Wood, NW8 £450,000 Subject to contract

This is a great opportunity to live within a short stroll to the Boundary Road shops, bars, restaurants and the famous Abbey Road studios. The property is arranged as a large reception with door to balcony, a separate kitchen with further balcony, two good sized double bedrooms, family bathroom and separate w/c. The apartment offers double glazing throughout and access to communal gardens. Close to Swiss Cottage (Jubilee Line), South Hampstead (Overground to Euston) and a short walk to Finchley Road (Metropolitan line) and the numerous Buses available from Finchley Road and Swiss Cottage. The O2 centre, cinema complex and Supermarkets are within easy walk.





2nd Floor

Greenaway House, Boundary Road NW8

Total Area: 699 ft<sup>2</sup> ... 64.9 m<sup>2</sup> (excluding balcony)

Floor plans are for identification and guideline purposes only, not to scale  
Compliant RICS code of measuring practice

## Property Overview

<b>Location</b>	St Johns Wood, NW8
<b>Price</b>	Asking Price £450,000
<b>Bedrooms</b>	2
<b>Bathrooms</b>	1
<b>Receptions</b>	1
<b>Tenure</b>	Leasehold
<b>Council</b>	Camden
<b>Tax Band</b>	C
<b>Current Ground Rent</b>	Approx £10
<b>Service Charge</b>	Approx £1,535 Per Annum
<b>Term</b>	Leasehold - 125 years from 24/04/2000

## Key Features

- Reception Room
- Separate Kitchen
- 2 Bedrooms
- Bathroom
- 2 Balconies
- Separate W/C
- Passenger Lift
- Communal Garden
- Great Location
- Close to Transport Links

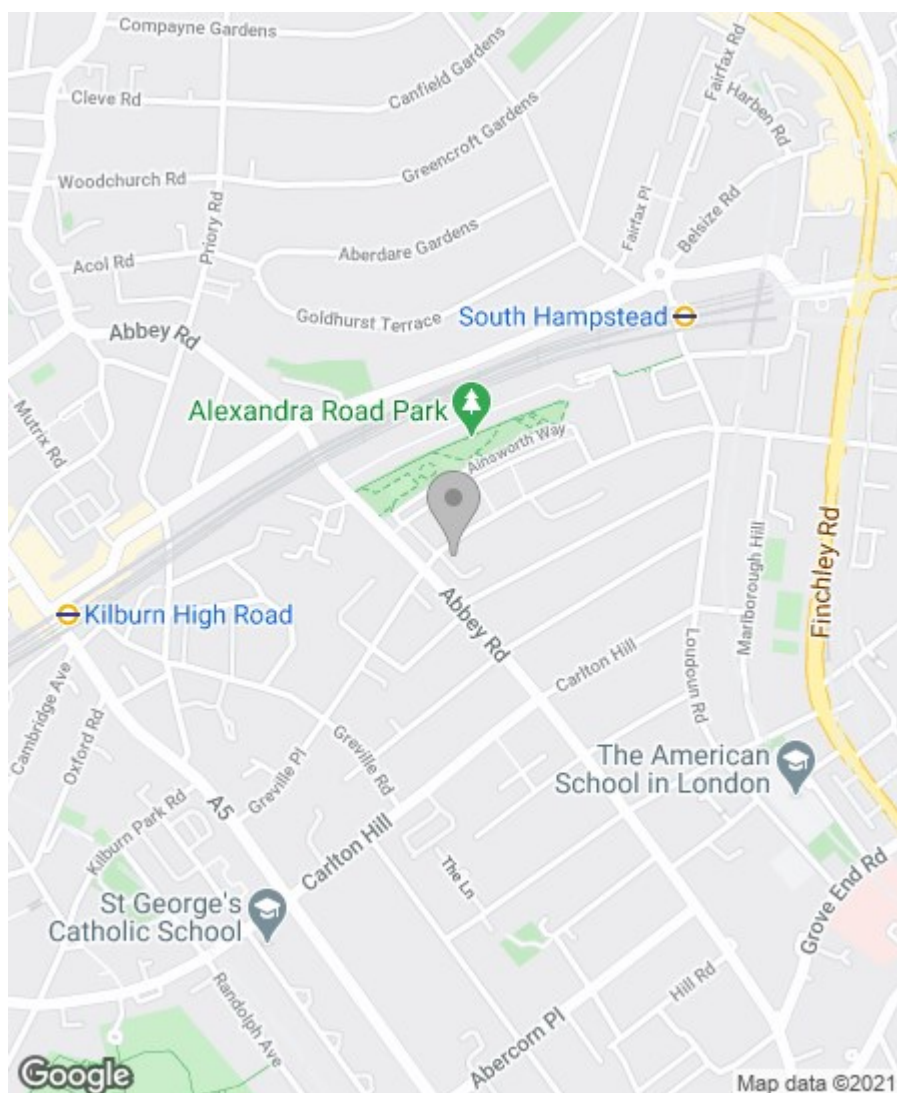

## Energy Efficiency Rating

	Current	Potential
Very energy efficient - lower running costs		
(92 plus) <b>A</b>		
(81-91) <b>B</b>		
(69-80) <b>C</b>		
(55-68) <b>D</b>	66	68
(39-54) <b>E</b>		
(21-38) <b>F</b>		
(1-20) <b>G</b>		
Not energy efficient - higher running costs		

## England & Wales

EU Directive  
2002/91/EC



## Environmental Impact (CO<sub>2</sub>) Rating

	Current	Potential
Very environmentally friendly - lower CO <sub>2</sub> emissions		
(92 plus) <b>A</b>		
(81-91) <b>B</b>		
(69-80) <b>C</b>		
(55-68) <b>D</b>	63	66
(39-54) <b>E</b>		
(21-38) <b>F</b>		
(1-20) <b>G</b>		
Not environmentally friendly - higher CO <sub>2</sub> emissions		

## England & Wales

EU Directive  
2002/91/EC



**IMPORTANT NOTICE:** All of the information is intended only as a guide to a prospective purchaser and does not constitute any part of an offer or contract. Any measurements or distances referred to herein are approximate only. Any information contained herein (whether in the text, plans or photographs) is given in good faith and cannot be relied upon as being a statement or representation of fact. Should you proceed with the purchase of the property, your solicitor must verify these details. We have not carried out a detailed survey nor tested the services, appliances and specific fittings. In accordance with current legislation we would advise you that the measurements on these particulars are imperial. The formula for conversion to metric is as follows: 1' (one foot) = 30.4cm (centimetres), 1m (one metre) = 3'29 (feet).

